

# M-series

for single phase alternating current, 2 pole

RH28M-2E



## Description

Motor technology: AC  
 Rated voltage  $U_N$ : 1~ 230 V $\pm$ 10 %\*  
 Rated frequency  $f_N$ : 50 Hz\*  
 Motor input power  $P_1$ : 0.51 kW\*  
 Rated current  $I_N$ : 2.20 A\*  
 Rated speed  $n_N$ : 2720 min<sup>-1</sup>\*  
 Starting current  $I_s$ : 4.60 A  
 Service capacitor  $C_{400V}$ : 10.0  $\mu$ F  
 Dynamic pressure:  $p_{d2} = 6 \cdot 10^{-6} \cdot q_v^2$  [Pa]  
 Thermal class: **THCL155**\*  
 Min. permitted ambient temperature  $t_{R(min)}$ : -25 °C  
 Max. permitted ambient temperature  $t_{R(max)}$ : 60 °C  
 Protection class: IP10  
 Motor protection: Thermal contact  
 Impeller : Aluminium, uncoated  
 Motor: 1 coat paint, pebble grey  
 \* Rated data

## Characteristic curve

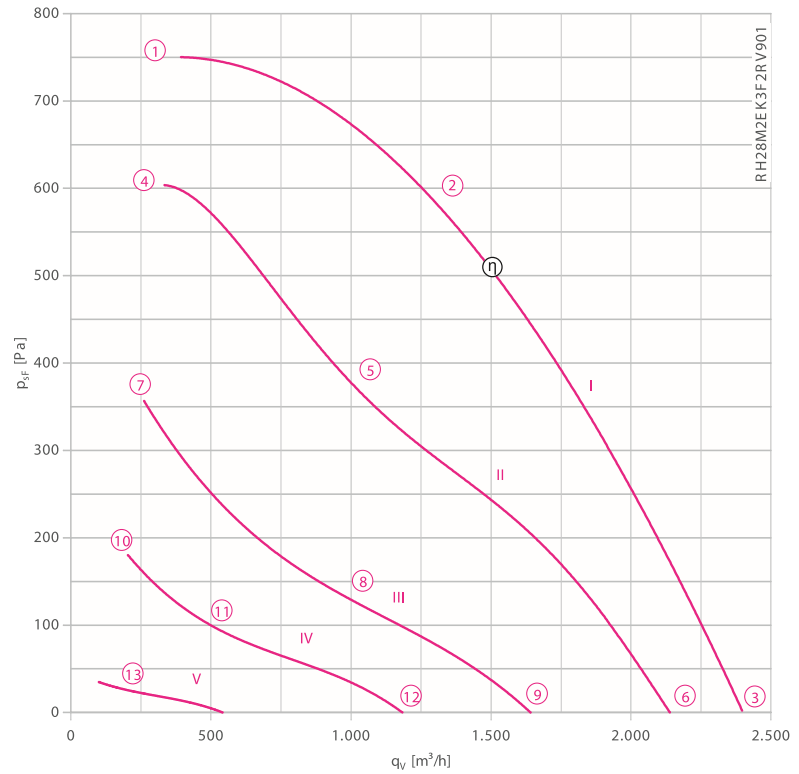

- Inlet ring 00275848 Page 451
- Connection diagram 1360-104XA SW Page 549
- System components Page 448

## Dimensions [mm]

Free-running motor impeller RH  
in installation position H/Vu/Vo

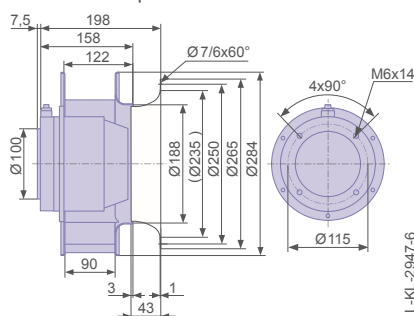

Free-running motor impeller RH  
in installation position H/Vu/Vo

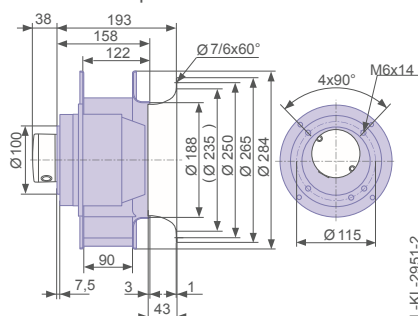



Performance data

Type	Characteristic curve	Voltage	Operating point	Current	Motor input power	Speed	Suction side sound power level
		U [V]		I [A]	P <sub>1</sub> [W]	n [min <sup>-1</sup> ]	
RH28M-2EK.3F.2R	I	230	①	1.70	410	2800	
		<b>230*</b>	②	<b>2.20*</b>	<b>510*</b>	<b>2720*</b>	80
		230	③	1.80	420	2800	85
	II	160	④	2.10	350	2520	
		160	⑤	2.70	440	2140	74
		160	⑥	2.20	360	2500	82
	III	130	⑦	2.30	310	1960	
		130	⑧	2.60	340	1540	65
		130	⑨	2.30	300	1920	75
	IV	105	⑩	2.10	230	1400	
		105	⑪	2.20	230	1100	56
		105	⑫	2.10	220	1410	66
	V	60	⑬	1.30	77	530	



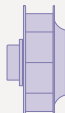

\*rated data

Fan ordering information

Design	RH*	RH*
Installation position	H/Vu/Vo	H/Vu/Vo
Electrical connection	Supply cable lateral 105cm	Terminal box
		
<b>Type</b>	<b>RH28M-2EK.3F.2R</b>	<b>RH28M-2EK.3F.2R</b>
<b>Article no.</b>	<b>109326</b>	<b>121898</b>
Weight [kg]	7.10	7.10

\* Inlet ring not included

Control technology

<p>Frequency inverter Fcontrol 1~</p>  <p>➤ Page 478</p>	<p>Motor protection units 1~</p>  <p>➤ Page 526</p>	<p>Transformer-based controllers 1~</p>  <p>➤ Page 517</p>	<p>Electronic voltage controllers 1~</p>  <p>➤ Page 492</p>
---	--	---	---